

LUXE



110 Nelson Road Central, Great Yarmouth, Norfolk, NR30 2NJ

£1,550 PCM

- Modern Throughout
- Modern Kitchen
- Two Bathrooms
- Fully Renovated
- Lots of Space
- Five Bedrooms
- EPC Rating C
- Permit Parking

110 Nelson Road Central, Norfolk NR30 2NJ

This home is located in the popular town of Great Yarmouth, with five bedrooms and two bathrooms plus a rear private garden,



Council Tax Band: C

This home is located in the popular town of Great Yarmouth, the UK's third most desired seaside destination, also adjoining to the highly sought-after Norfolk Broads. The town benefits from a wide range of local amenities and great leisure facilities including schooling, supermarkets, shopping centre, pubs, restaurants, bars, cinema, swimming pool and theme parks. The town has its own train and stations with fantastic transport links into the Cathedral City of Norwich (approx. 30 min drive).

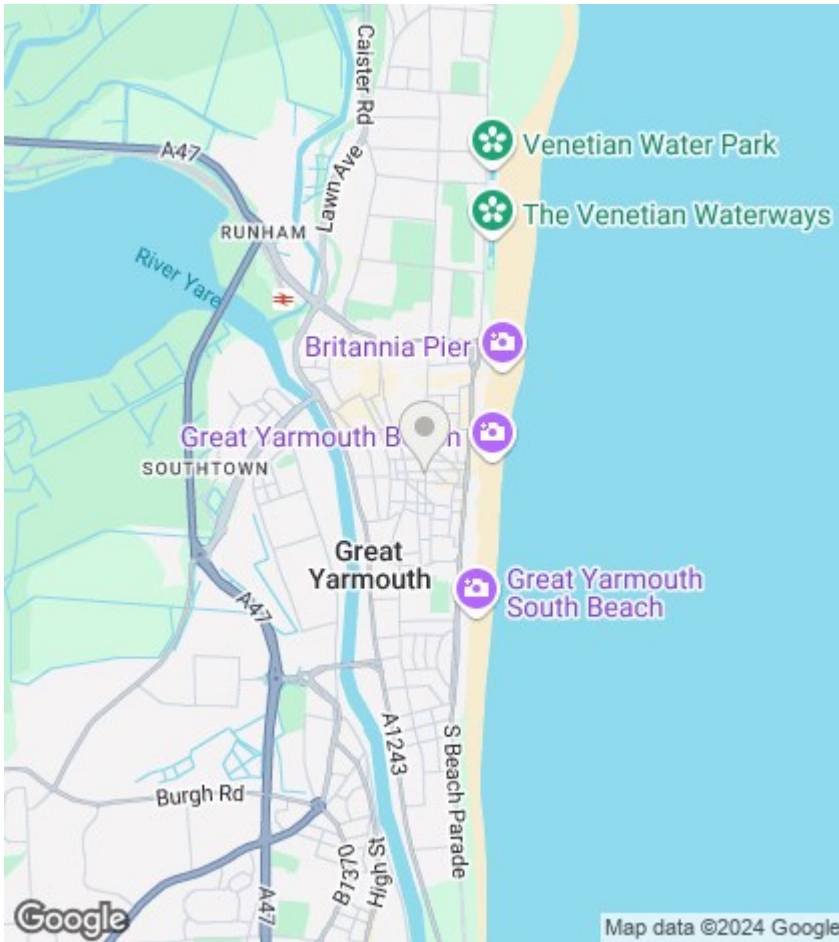

Directions

, Great Yarmouth

Viewings

Viewings by arrangement only. Call 0203 551 6141 to make an appointment.

EPC Rating:

Energy Efficiency Rating		Current	Potential
Very energy efficient - lower running costs			
(92 plus) A			
(81-91) B			
(69-80) C			
(55-68) D			
(39-54) E			
(21-38) F			
(1-20) G			
Not energy efficient - higher running costs			
England & Wales		EU Directive 2002/91/EC	

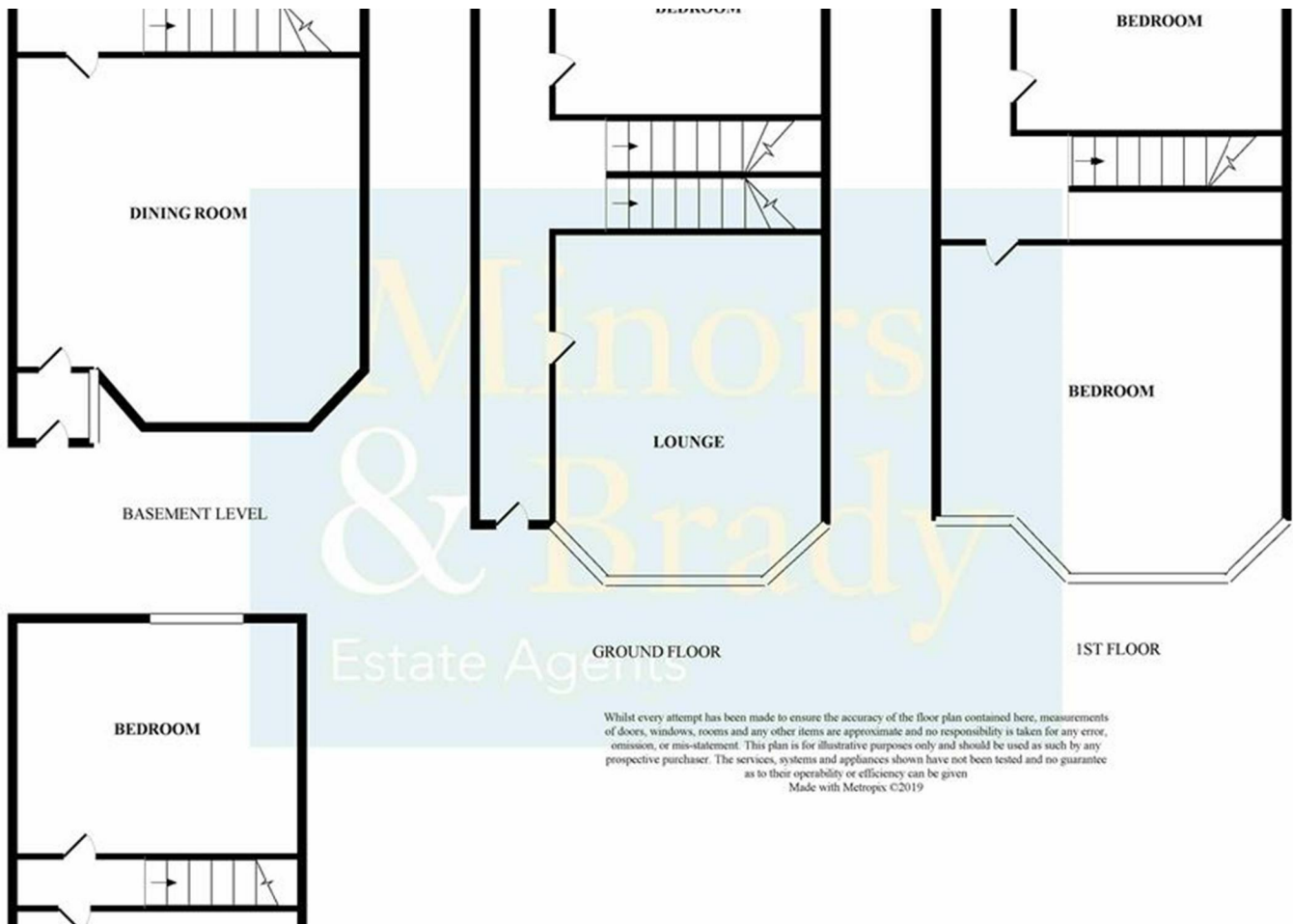

Whilst every attempt has been made to ensure the accuracy of the floor plan contained here, measurements of doors, windows, rooms and any other items are approximate and no responsibility is taken for any error, omission, or mis-statement. This plan is for illustrative purposes only and should be used as such by any prospective purchaser. The services, systems and appliances shown have not been tested and no guarantee as to their operability or efficiency can be given.
 Made with Metropex ©2019